

# Disinfectant dispenser; non-contact with spray; on the wall installation bracket

Ord. code: DD-MOL-010



**assembled  
in Slovakia**

The non-contact disinfectant dispenser integrated on the on the wall installation bracket. With solid construction made of stainless steel with attractive design. The smooth surface is easy to clean.

## General information

The non-contact spray disinfection dispenser can be used with the following fillings:

- liquid with alcohol content up to 75%
- Oxychlorine with an active substance concentration of 0.03%
- other chlorine-based disinfectants: Cl max. 50 ml / 1 l

## Description of controls and main components of the dispenser

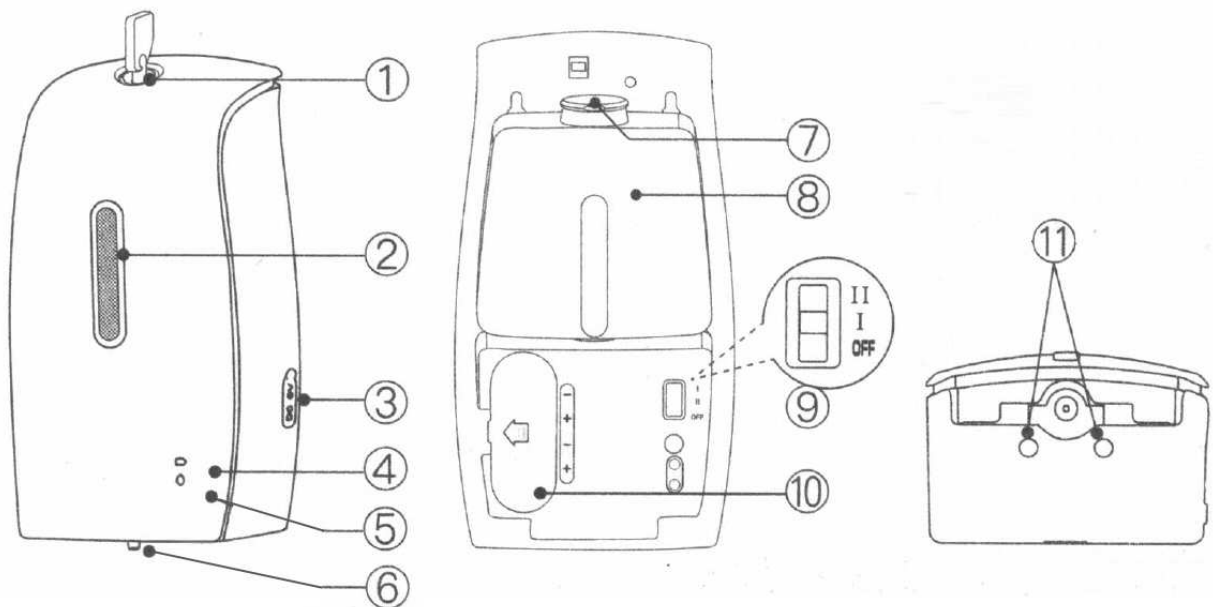

- ① key (lock off the front cover)
- ② disinfectant level control window
- ③ connector for 230 V / 6 V DC power adapter
- ④ red LED (battery status)
- ⑤ green LED (operation status)
- ⑥ dosing nozzle (sprayer)
- ⑦ disinfectant reservoir filler neck
- ⑧ disinfectant reservoir
- ⑨ main switch / single disinfection dose size switch
- ⑩ battery compartment (water resistant)
- ⑪ IR sensors

## Installation on the wall

Select a suitable location for mounting the disinfection dispenser. It should be a flat, smooth surface indoors and out of direct sunlight and out of reach of the heat source.

For assembly, you can use the installation material, which is intended for brick masonry and concrete structures and is part of the package. Use suitable dowels or anchors for mounting on plasterboard or lightweight building walls.

- Place the rear metal bracket on the wall at a suitable height (lower edge of the rear bracket approx. 970 mm from the floor for adults and approx. 750 mm for children) and mark 6 holes - *Fig. 1*.
- Drill 6 holes with a diameter of 6 mm to a depth of 30 mm and insert the enclosed dowels into them.
- Place the rear bracket on the wall and screw it on with enclosed 4 x 15 mm cross head screws.
- Place the dispenser with the stainless steel plate mounted on the rear bracket so that the protruding "tab" fits into the cut-off on the rear wall-mounted bracket, press it over the entire surface against the rear bracket and then slide it all the way down - *Fig. 2*.
- Unlock the front cover of the dispenser with the plastic key (included in the package) and open the front cover of the dispenser.
- Use 2 enclosed M5x10 screws with Torx 25 head to firmly attach the dispenser to the rear bracket - *Fig. 3*.
- Insert the drip tray (part of the package) at an angle of approx. 45° into the holes in the lower part of the stainless steel plate of the dispenser and then lower it to a horizontal position - *Fig. 4*.

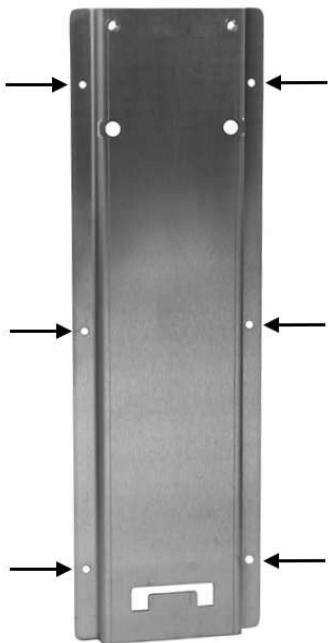

*Fig. 1 – rear bracket - fixation points on the wall*



*Fig. 2 – placing the dispenser to rear bracket*



Fig. 3 – fix the dispenser to the rear holder

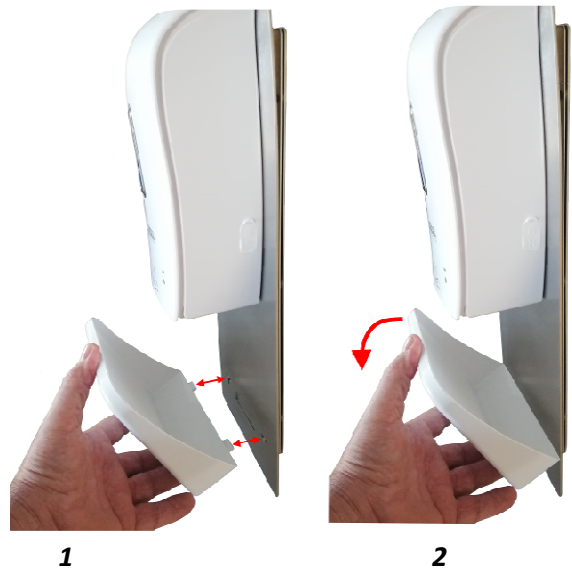

Fig. 4 – attaching the drip tray

## Filling with disinfectant

- Release the reservoir (item no. ⑧) by pushing it downwards and pulling the upper part with the cap towards you and then remove it upwards and towards you - Fig. 5.
- Fill the tank with a suitable disinfectant solution (see page 7 of this manual). Be careful not to overfill the tank.
- Tighten the reservoir cap tightly.
- If disinfectant is spilled on the tank during filling, wipe it dry before putting it back in the dispenser.
- Insert the reservoir back into the dispenser at a 45° angle and, after inserting the outlet of the tank into the dispenser pump, secure it by moving it downwards and backwards, thus locking it in the dispenser – Fig. 6.



Fig. 5 – removing the reservoir

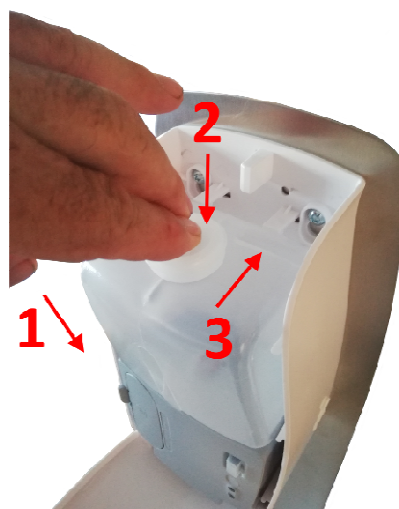
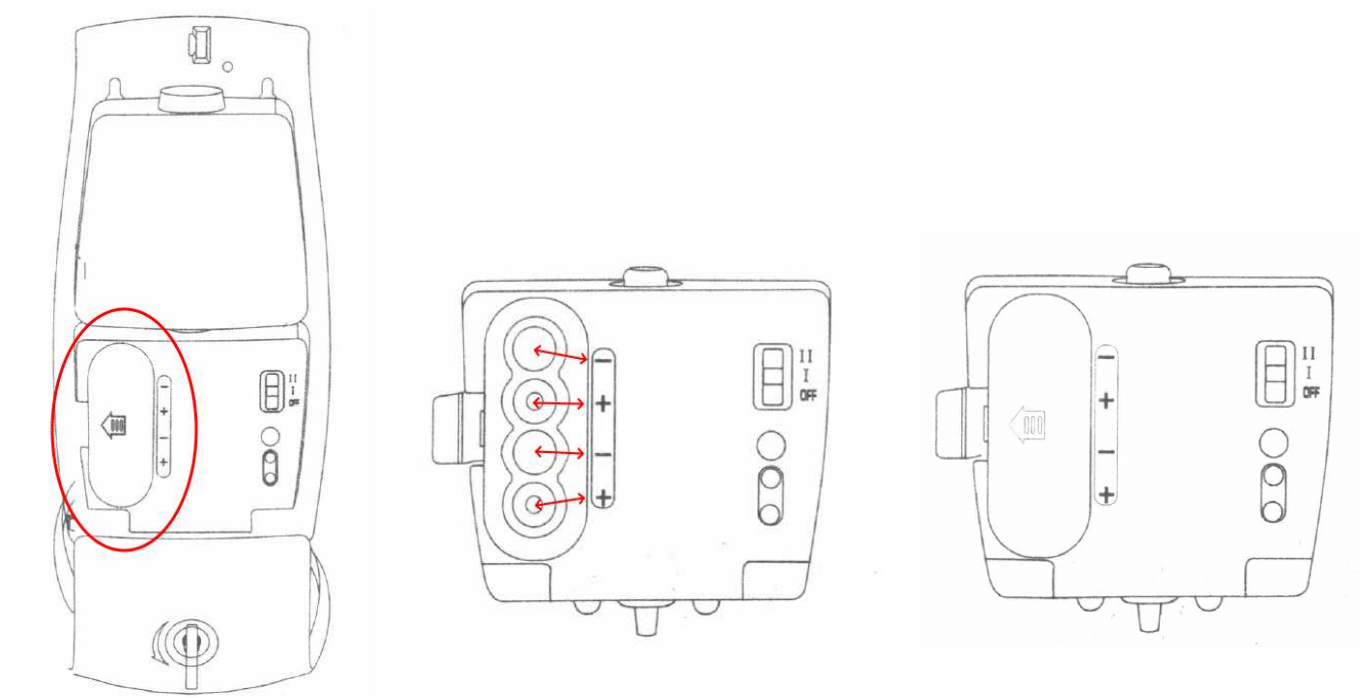

Fig. 6 – inserting back the reservoir

## Inserting the batteries



Gently push and slide the battery cover in the direction of the arrow

Insert 4 pcs of new **alkaline batteries** AA type type so that the polarity of the inserted batteries is in accordance with the marking polarity on the dispenser motor body

Insert back the battery cover

Then turn the main switch to position I or II to select a single dose size (0.5 or 1.0 ml) and close the front cover. The dispenser is set to energy saving mode and "waits" for the hands to approach the detection space under the dispenser nozzle.

The battery compartment has a water-resistant design.

If you want to use the AC adapter instead of the batteries to power the dispenser, insert the 230 V/50 Hz 6 VDC 1 A power adapter connector into the power connector located on the right side of the dispenser.



**Use only a certified power adapter DD-MOL-303 for this type of dispenser to prevent possible damage to the dispenser by using an unsuitable power adapter.**

## Description of LED signaling

- The red LED flashes when the dispenser is switched on, when the dose size is set and when the front cover is opened / closed.
- Green LED - lights up once for 1 second when the dose size is switched, followed by a flashing of the red LED once when switching to position I, resp. The red LED flashes twice when switching to position II.
- Green LED - flashes once each time a hand is placed under the dispenser within range of the sensor and the green LED lights up while the dispenser motor is running.
- Signaling of supply voltage drop below 4.8 V:
  - The red LED flashes every 3 seconds when the supply voltage is in the range of 3.9 V - 4.8 V, the dispenser is still working (spray disinfectant after detecting a hand under the sensor).
  - When the supply voltage drops below 3.9 V, the red LED flashes twice each time the dispenser sensor is activated, but the dispenser no longer works (disinfectant does not spray out).

## Use and maintenance

- Do not expose the dispenser to direct sunlight or elevated ambient temperatures.
- The detection range of the sensor is 2 – 10 cm ( $\pm 2$  cm).
- Use only the recommended types of disinfectants in the dispenser:
  - Alcohol based
  - Water based with active additives



**Do not use disinfectant gels or foam disinfectants in this type of dispenser (spray).**

- After filling the disinfectant reservoir, allow the dispenser to spray several times to expel possible air bubbles from the disinfectant distribution ways in the dispenser.
- Setting the single dose volume:
  - Open the front cover, set the switch to position "I" for a 0.5 ml dose of disinfectant or to position "II" for a 1.0 ml dose. In position 0, the dispenser is switched off.
- When the dispenser motor is running but the sprayer does not dispense disinfectant, please check and add disinfectant.



**Do not let the dispenser run idle, as this could damage it!**

- When operating the dispenser with weaker (discharged) batteries, the dose of disinfectant solution may be smaller and the spray angle smaller.
- Do not use acid, solvent or abrasive cleaners to clean the dispenser.
- Rinse the outer cover of the dispenser with detergent and water or use a detergent containing alcohol.
- When cleaning the dispenser, make sure that the cleaning agent does not get into the disinfectant reservoir.
- If the dispenser will not be used for a long time, remove the batteries and empty the disinfectant reservoir.

## Recommendet disinfectant refills

Ordering code	Product description
DD-MOL-201	Alcohol based disinfectant with glycerine for direct use in hand dispenser; 5 l container
DD-MOL-202	Alcohol based disinfectant with glycerine for direct use in hand dispenser; 1 l bottle
DD-MOL-203	Solution for hands disinfection Steriland DERMA with HCl 0,025 %; for direct use in disinfection dispenser; 5 L
DD-MOL-204	Solution for hands disinfection Steriland DERMA with HCl 0,025 %; for direct use in disinfection dispenser; 1 L
DD-MOL-207	Alcohol based disinfectant with glycerine for direct use; 1 l bottle
DD-MOL-208	Disinfectant on alcohol base with glycerine and aloe vera; for direct use; 5 l
DD-MOL-209	Alcohol based disinfectant with glycerine for direct use; 1 l bottle

## Recommended power adapter

Ordering code	Product description
DD-MOL-303	Power adapter 6 V / 2000 mA



Before storing, moving or transporting in a position other than upright and when sending the dispenser for service, please empty the disinfectant reservoir to prevent it from leaking out!